

Clamping Sets SIG

Material: Stainless steel 1.4301



The clamping sets SIG are connecting elements used to connect a shaft, e.g., a spindle or a motor shaft, with a drive wheel. The clamping set consists of three parts and allows to fix a cylindrical shaft inside a cylindrical bore in the drive wheel.

- No machining of the shaft required, i.e., no keyway, no cross-hole, no thread, etc.
- The connection can be disassembled with a puller.
- Minimal space requirement.

M = Torque max. (Nm).

Required tolerances: Shaft: h7.

Bore of the part to be clamped: H7.

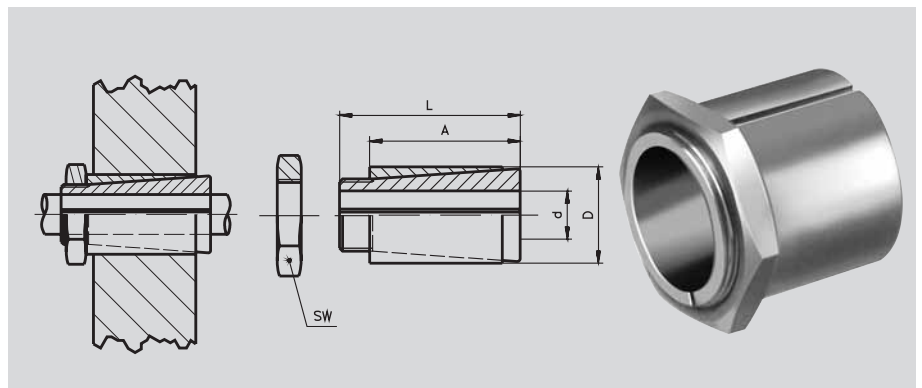

Ordering Details: e.g.: Product No. 615 104 00, Clamping Set SIG, 4 mm

Product No.	d mm	D mm	L mm	A mm	Thread	SW mm	Torque M_{max} Nm	Fastening Torque Nm	Weight g
615 104 00	4.00	8	15	12.5	M6x0.5	8	3	4	3.8
615 105 00	5.00	10	15	12.5	M8x0.5	10	4	5	6.5
615 106 00	6.00	10	15	12.5	M8x0.5	10	7	8	5.3
615 106 35	6.35	10	15	12.5	M8x0.5	10	7	8	5.0
615 107 00	7.00	12	15	12.0	M10x0.75	12	8	9	6.3
615 108 00	8.00	14	22	19.0	M12x1	16	14	15	17.5
615 109 00	9.00	14	22	19.0	M12x1	16	14	15	15.0
615 109 52	9.52	14	22	19.0	M12x1	16	14	15	12.8
615 110 00	10.00	17	22	18.5	M15x1	18	18	19	29.0
615 111 00	11.00	17	22	18.5	M15x1	18	18	19	28.0
615 112 00	12.00	17	22	18.5	M15x1	18	18	19	26.2
615 114 00	14.00	20	28	23.0	M17x1	20	24	25	35.3
615 115 00	15.00	20	28	23.0	M17x1	20	24	25	36.4
615 115 88	15.88	23	28	23.0	M20x1	26	26	27	48.4
615 116 00	16.00	23	28	23.0	M20x1	26	26	27	50.7
615 117 00	17.00	23	28	23.0	M20x1	26	26	27	45.0
615 119 00	19.00	25	28	23.0	M22x1	27	29	30	46.9
615 120 00	20.00	28	28	23.0	M25x1	30	31	32	67.0

Mounting

- The clamping set has to be mounted without lubrication to achieve the torques stated above.
- The clamping set has to be fully in contact with the shaft.
- To achieve the maximum torque, shaft and hub have to have sufficient strength (minimum elastic limit 350 N/mm², e.g. C45).
- The clamping set must not get in contact with any fixed components (e.g. bearing housing or crankcase).