

Shrink Disks ST

Material: 42CrMo4 quenched, pressure sleeves forged

Characteristics:

- very high transfer of torques
- no axial shaft-hub movement
- quick mounting
- quick demounting

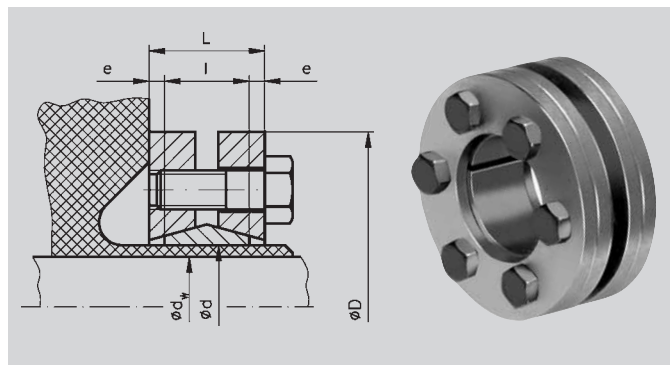

Ordering Details: e.g.: Product No. 615 814 00, Shrink Disk Inner-Ø 14 mm

| Product No. | Inner-Ø mm | Shaft-Ø ¹⁾ d _w mm | Torque ²⁾ M _t Nm | Axial Load ²⁾ F _a kN | D mm | l mm | L mm | e mm | Tensioning Screws DIN 931 N. x Size | Fastening Torque M _s Nm | Contact Pressure p _w N/mm ² | Weight kg |
|-------------|---------------|-----------------------------------------------|----------------------------------------------|--------------------------------------------------|---------|---------|---------|---------|-------------------------------------------|------------------------------------------|---------------------------------------------------------|--------------|
| 615 814 00 | 14 | 10 | 40 | 10 | 38 | 10 | 15 | 2.5 | 4xM5 | 3 | 343 | 0.1 |
| | | 11 | 50 | 12 | | | | | | | | |
| | | 12 | 60 | 14 | | | | | | | | |
| 615 816 00 | 16 | 12 | 65 | 14 | 41 | 12 | 17 | 2.5 | 4xM5 | 3 | 313 | 0.1 |
| | | 13 | 80 | 16 | | | | | | | | |
| | | 14 | 95 | 18 | | | | | | | | |
| 615 824 00 | 24 | 19 | 220 | 32 | 50 | 15 | 21 | 3 | 6xM5 | 5 | 357 | 0.2 |
| | | 20 | 270 | 35 | | | | | | | | |
| | | 21 | 320 | 37 | | | | | | | | |
| 615 830 00 | 30 | 24 | 390 | 38 | 60 | 18 | 23 | 2.5 | 7xM5 | 5 | 292 | 0.3 |
| | | 25 | 430 | 41 | | | | | | | | |
| | | 26 | 470 | 43 | | | | | | | | |
| 615 836 00 | 36 | 28 | 440 | 50 | 72 | 22 | 25 | 1.5 | 5xM6 | 12 | 307 | 0.4 |
| | | 30 | 570 | 58 | | | | | | | | |
| | | 31 | 630 | 58 | | | | | | | | |
| 615 844 00 | 44 | 32 | 740 | 62 | 80 | 22 | 26 | 2 | 7xM6 | 12 | 283 | 0.6 |
| | | 35 | 940 | 72 | | | | | | | | |
| | | 36 | 1020 | 75 | | | | | | | | |
| 615 850 00 | 50 | 38 | 1270 | 89 | 90 | 22 | 30 | 4 | 9xM6 | 12 | 320 | 0.8 |
| | | 40 | 1440 | 96 | | | | | | | | |
| | | 42 | 1630 | 103 | | | | | | | | |
| 615 855 00 | 55 | 42 | 1160 | 79 | 100 | 22 | 31 | 4.5 | 8xM6 | 12 | 250 | 1.1 |
| | | 45 | 1520 | 88 | | | | | | | | |
| | | 48 | 1880 | 97 | | | | | | | | |
| 615 862 00 | 62 | 48 | 2220 | 125 | 110 | 22 | 32 | 5 | 12xM6 | 12 | 330 | 1.3 |
| | | 50 | 2620 | 132 | | | | | | | | |
| | | 52 | 2890 | 135 | | | | | | | | |
| 615 868 00 | 68 | 50 | 2000 | 97 | 115 | 23 | 33 | 5 | 10xM6 | 12 | 260 | 1.4 |
| | | 55 | 2500 | 106 | | | | | | | | |
| | | 60 | 3150 | 120 | | | | | | | | |

¹⁾ Shaft-Ø of customer (example). ²⁾ Transferrable values with shaft-Ø d_w of customer

Mounting

Clean and slightly lubricate the contact surfaces of shaft and hub. Place clamping set on the hollow shaft. Fasten the tensioning screws evenly, step by step until the fastening torque M_s of the table is reached. To reach the value stated in the table several fastening steps are required. The figures for M_t and F_a stated in the table were calculated for an assembly with oil.

Attention: Do not use any lubricant containing molybdenum sulphide.

Demounting

Evenly unscrew all tensioning screws one by one. Do not fully remove the screws from the thread. The clamping element usually disengages on its own. One good turn is sufficient.

Tolerances, Surface Roughness

Highest permissible surface roughness: R_t=16 µm.
Largest permissible tolerances: d = h8 for the shaft.

Tolerances for d_w/d

For d_w from 18 - 30 mm: H6/j6

For d_w from 31 - 50 mm: H6/h6

For d_w from 51 - 60 mm: H6/g6

Axial Displacement

No axial movement between hub and shaft can occur while fastening the screws.