

## Precision Double Shaft Blocks GWD-3 ISO Series 3

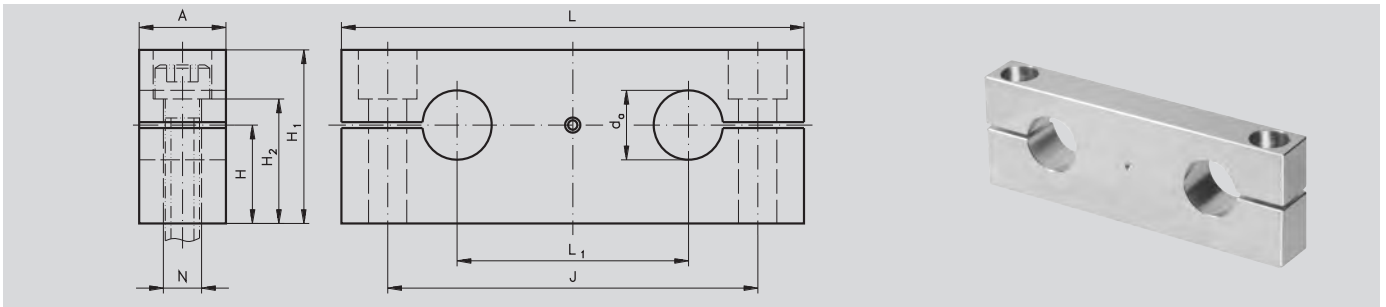

**Material:** Extruded aluminium.  
Matching quadro linear-bearing units KGQ-3 of the ISO Series 3, page 406.

Shaft blocks are practical and robust machine elements, that provide a simple way of attaching the guiding shaft of the linear bearings on the respective machine parts. They allow true to size and, most important, cost efficient constructions.

Ordering Details: e.g.: Product No. 646 412 02, Precision Shaft Block GWD-3 for Shaft-Ø 12 mm

Product No.	$d_a$ mm	A mm	H mm	$H_1$ mm	$H_2$ mm	J mm	L mm	$L_1$ mm	$N^*$ mm	Weight g
646 412 02	12	14	18	32	23.5	70	85	42	6.6	90
646 416 02	16	18	20	37	26.5	82	100	54	9	140
646 420 02	20	20	25	46	32.5	108	130	72	11	250
646 425 02	25	25	30	56	40	132	160	88	13.5	470
646 430 02	30	25	35	64	48	150	180	96	13.5	620
646 440 02	40	30	44	80	59	190	230	122	17.5	1150
646 450 02	50	30	52	96	75	240	280	152	17.5	1700

\*For cylindrical screws with Allen screw according to DIN 912 or ISO 4762.

Shaft steel page 394.

## Precision Shaft Steel with Shaft Support

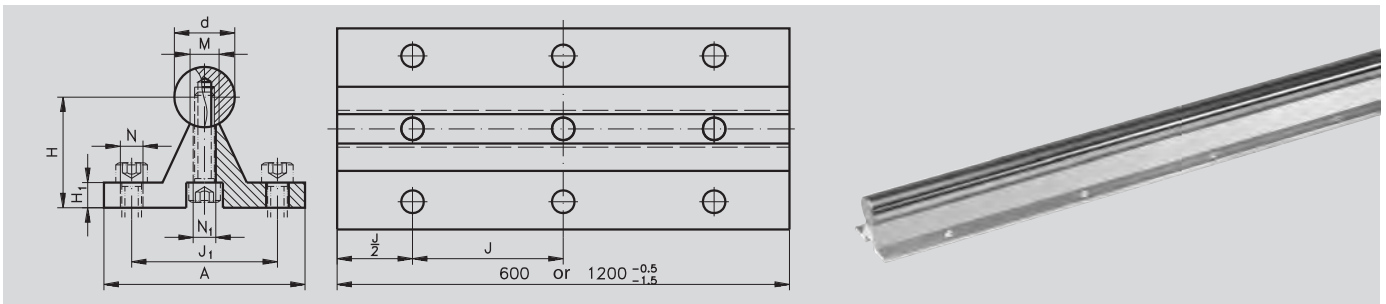

**Material:** Steel 1.1213 (Cf53), hardened and ground, hardness  $62 \pm 2$  HRC, diameter tolerance ISO h6.

**Material support:** Extruded aluminium.

**Length:** Either 600 mm or 1200 mm.

Ready-to-use, mounted, supported linear shafts to be used with open linear bearings or open linear bearing units. The shafts are supported over their entire length. The shaft supports have mounting holes for mounting them on a base plate. Unit can be shortened by the customer using an angle grinder. Longer versions on request.

Ordering Details: e.g.: Product No. 647 412 03, Shaft with Support, Ø 12 mm, Length 600 mm

Product No. Length 600 mm	Product No. Length 1200 mm	d mm	A mm	$H_{\pm 0.02}$ mm	$H_1$ mm	J mm	$J_1$ mm	M mm	N mm	$N_1$ mm	$\beta$ Degrees	Mounting Screw DIN 912	Weight 600 mm g	Weight 1200 mm g
647 412 03	647 412 04	12	40	22	5	75	29	5.8	4.5	4.5	50	M4x16	1080	2160
647 416 03	647 416 04	16	45	26	5	100	33	7	5.5	5.5	50	M5x20	1610	3220
647 420 03	647 420 04	20	52	32	6	100	37	8.3	6.6	6.6	50	M6x25	2444	4888
647 425 03	647 425 04	25	57	36	6	120	42	10.8	6.6	9	50	M8x25	3460	6920
647 430 03	647 430 04	30	69	42	7	150	51	11	9	11	50	M10x30	4840	9680
647 440 03	647 440 04	40	73	50	8	200	55	15	9	11	50	M10x35	7820	15640
647 450 03	647 450 04	50	84	60	9	200	63	19	11	13.5	46	M12x40	11780	23560

Shaft steel without shaft support page 394.