

Shrink Disks ST

Material: 42CrMo4 quenched.

- For very high torques.
- No axial shaft-hub movement.
- Quick mounting.
- Quick demounting.

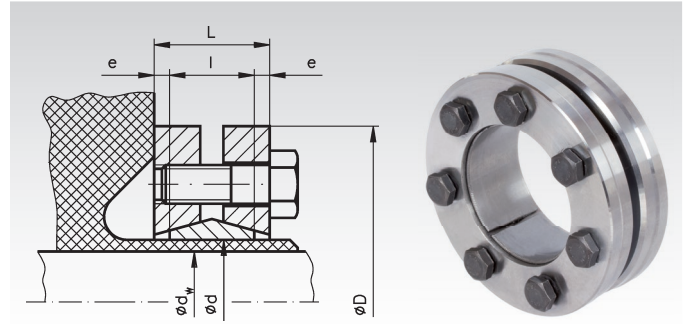

Ordering Details: e.g.: Product No. 615 814 00, Shrink Disk Inner-Ø 14 mm

Product No.	Inner-Ø d mm	Shaft-Ø ¹⁾ d _w mm	Torque ²⁾ T Nm	Axial Load ²⁾ F _{ax} kN	D mm	l mm	L mm	e mm	Screws DIN 931 No. x Size	Fastening Torque T _A Nm	Contact- pressure P _N N/mm ²	Weight kg
615 814 00	14	10	39	10	38	10	15	2,5	4x M5	3	343	0,1
		11	51	12								
		12	63	14								
615 816 00	16	12	66	14	41	12	17	2,5	4x M5	3	313	0,1
		13	78	16								
		14	96	18								
615 818 00	18	14	83	16	44	12	17	2,5	4x M5	4	298	0,1
		15	102	18								
		16	132	20								
615 824 00	24	19	220	32	50	15	21	3	6x M5	5	357	0,2
		20	272	35								
		21	325	37								
615 830 00	30	24	390	38	60	18	23	2,5	7x M5	5	292	0,3
		25	435	41								
		26	465	43								
615 836 00	36	28	442	50	72	19	25	3	5x M6	12	307	0,4
		30	575	58								
		31	633	58								
615 838 00	38	29	660	62	72	21	27	3	6x M6	12	341	0,5
		30	720	65								
		31	750	64								
615 844 00	44	32	740	62	80	22	26	2	7x M6	12	283	0,6
		35	940	72								
		36	1010	75								
615 850 00	50	38	1275	89	90	22	30	4	9x M6	12	320	0,8
		40	1430	96								
		42	1635	103								
615 855 00	55	42	1170	79	100	23	31	4	8x M6	12	250	1,1
		45	1500	88								
		48	1870	97								
615 862 00	62	48	2220	125	110	23	32	4,5	12x M6	12	330	1,3
		50	2600	132								
		52	2900	135								
615 868 00	68	50	2010	97	115	23	33	5	10x M6	12	260	1,4
		55	2505	106								
		60	3140	120								
615 875 00	75	55	2515	119	138	25	33	4	7x M8	30	272	2,4
		60	3195	137								
		65	3940	155								

¹⁾ Shaft-Ø of the customer's machine (for example). ²⁾ Transmittable values with shaft-Ø d_w of the customer's machine.

More sizes up to inner-Ø d=300mm, for shaft diameter 240mm and 292,000Nm are available.

Price and delivery time on request.

Mounting

Clean and slightly lubricate the contact surfaces of shaft and hub. Place clamping set on the hub. Fasten the tensioning screws evenly, step by step until the fastening torque T_A of the table is reached. To reach the value stated in the table several fastening steps are required. The figures for T and F_{ax} stated in the table were calculated for an assembly with oil.

Attention: Do not use any lubricant containing molybdenum sulphide.

Demounting: Evenly unscrew all tensioning screws one by one. Do not fully remove the screws from the thread. The clamping element usually disengages on its own.

Tolerances, Surface Roughness

One good turn is sufficient.
Highest permissible surface roughness: R_t=12.5µm.

Tolerances for d_w/d: h8/H8.