

Adjusting Rings (Shaft Collars with Set Screw) according to the Old Standard DIN 703

Material: Steel, blank.
 Steel, black oxide finish.
 Steel, zinc-plated.
 Stainless steel 1.4305.



Heavy-duty series. With allen set screw made from steel / steel zinc-plated like DIN EN ISO 4027, but strength 12.9 or stainless steel A2. From size $d_1=70\text{mm}$ with 2 set screws, with offset 135° .

Blank turned and kalibrated. Bores tolerance H8.
 Large chamfer on one side of the outside diameter.
 Temperature range: -40°C to $+175^\circ\text{C}$.

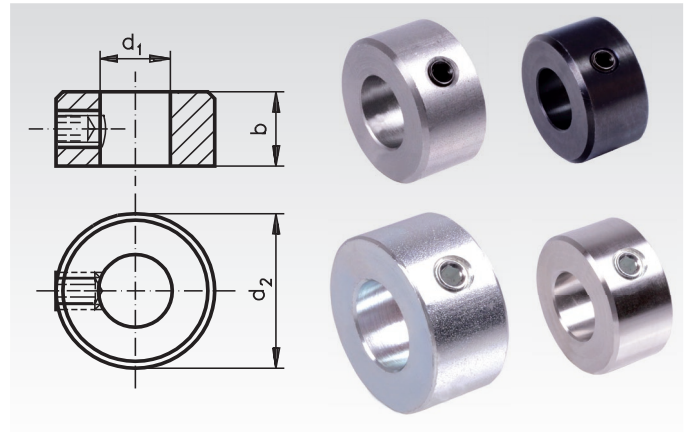

Ordering Details: e.g.: Product No. 623 220 00,
 Collar DIN 703, 20 mm Bore

| Product No. Steel blank | Product No. Steel black oxidized | Product No. Steel zinc-plated | Product No. Stainless Steel | d_1 mm | d_2 mm | b mm | Screw mm | Weight kg p. % |
|----------------------------|-------------------------------------|----------------------------------|--------------------------------|-------------|-------------|---------|-------------|-------------------|
| 623 220 00 | 623 892 20 | 623 882 20 | 623 992 20 | 20* | 40 | 20 | M8 | 14,6 |
| 623 225 00 | 623 892 25 | 623 882 25 | 623 992 25 | 25 | 56 | 22 | M10 | 33,8 |
| 623 230 00 | 623 892 30 | 623 882 30 | 623 992 30 | 30 | 63 | 22 | M10 | 41,5 |
| 623 235 00 | 623 892 35 | 623 882 35 | 623 992 35 | 35 | 70 | 22 | M10 | 49,6 |
| 623 240 00 | 623 892 40 | 623 882 40 | 623 992 40 | 40 | 80 | 28 | M12 | 82,7 |
| 623 245 00 | 623 892 45 | 623 882 45 | 623 992 45 | 45 | 80 | 28 | M12 | 75,3 |
| 623 250 00 | 623 892 50 | 623 882 50 | 623 992 50 | 50 | 90 | 28 | M12 | 96,3 |
| 623 255 00 | 623 892 55 | 623 882 55 | 623 992 55 | 55 | 90 | 28 | M12 | 87,1 |
| 623 260 00 | 623 892 60 | 623 882 60 | 623 992 60 | 60 | 100 | 28 | M12 | 110 |
| 623 265 00 | 623 892 65 | 623 882 65 | 623 992 65 | 65 | 100 | 28 | M12 | 99,6 |
| 623 270 00 | 623 892 70 | 623 882 70 | 623 992 70 | 70 | 110 | 32 | M16 | 141 |
| 623 275 00 | 623 892 75 | 623 882 75 | 623 992 75 | 75 | 110 | 32 | M16 | 127 |
| 623 280 00 | 623 892 80 | 623 882 80 | 623 992 80 | 80 | 125 | 32 | M16 | 181 |
| 623 285 00 | 623 892 85 | 623 882 85 | 623 992 85 | 85 | 125 | 32 | M16 | 165 |
| 623 290 00 | 623 892 90 | 623 882 90 | 623 992 90 | 90 | 125 | 32 | M16 | 148 |

* Size 20 is not part of the old standard DIN 703.

Other sizes and inch-sizes on request.