

## HTD Pulleys, Profile 8M for Taper Bushes

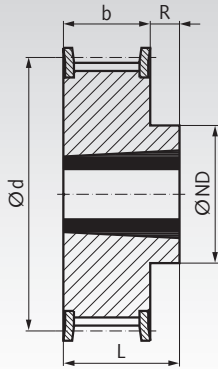

**Material:** Up to a Teeth Number of 72 phosphated steel, from a Teeth Number of 80 phosphated grey cast iron GG25.



Type 10F

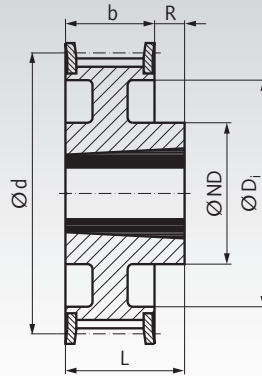

Type 11F

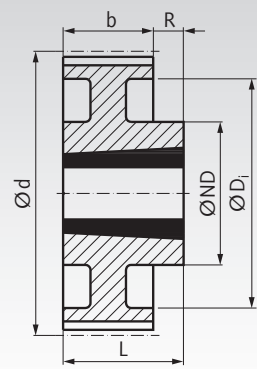

Type 11

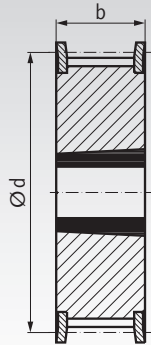

Type 15F

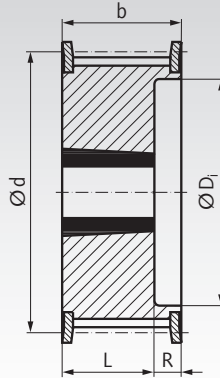

Type 16F

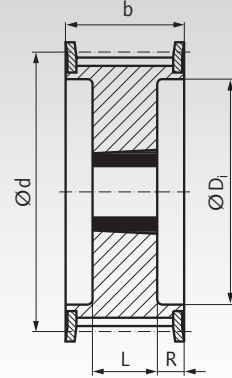

Type 18F

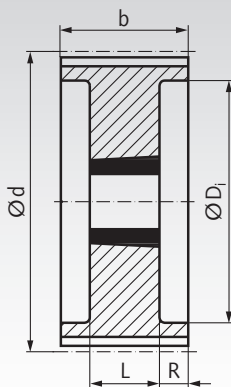

Type 18

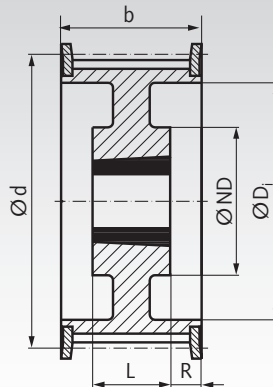

Type 19F

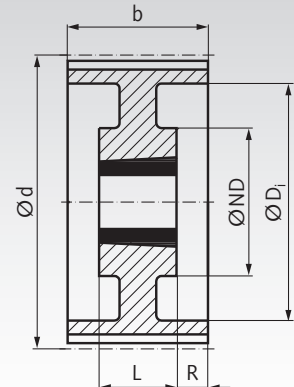

Type 19

## HTD Pulleys, Profile 8M for Taper Bushes

Material: Up to a Teeth Number of 72 phosphated steel, from a Teeth Number of 80 grey cast iron GG25 phosphated. Drawings see page 152.

### Timing Belt Width 20 mm

Ordering Details: e.g.: Product No. 174 771 11, Taper-Pulley, 8M, 22 Teeth for Width 20 mm

Product No. Belt Width 20mm	Number of teeth	Type	Outside Ø		d mm	ND mm	D <sub>i</sub> mm	b mm	L mm	R mm	Taper Bush Type page 340	Bore Ø		Weight kg
			Pulley mm	Flange mm								min. mm	max. mm	
174 771 11	22	16F	54,65	60	56,02	-	37	28	22	6	1008	9	25	0,25
174 771 12	24	16F	59,74	66	61,12	-	44	28	22	6	1108	9	28	0,30
174 771 13	26	16F	64,84	71	66,21	-	45	28	22	6	1108	9	28	0,36
174 771 14	28	16F	70,08	75	71,30	-	50	28	22	6	1108	9	28	0,45
174 771 15	30	16F	75,12	83	76,39	-	58	28	22	6	1108	9	28	0,55
174 771 16	32	16F	80,17	87	81,49	-	63	28	25	3	1610	12	42	0,43
174 771 17	34	16F	85,21	91	86,58	-	64	28	25	3	1610	12	42	0,57
174 771 18	36	16F	90,30	97	91,67	-	68	28	25	3	1610	12	42	0,70
174 771 19	38	16F	95,39	103	96,77	-	72	28	25	3	1610	12	42	0,82
174 771 20	40	16F	100,49	106	101,86	-	76	28	25	3	1610	12	42	1,10
174 771 22	44	10F	110,67	119	112,05	92	-	28	32	4	2012	12	50	1,20
174 771 24	48	10F	120,86	127	122,23	96	-	28	32	4	2012	12	50	1,65
174 771 28	56	10F	141,23	148	142,60	110	-	28	32	4	2012	12	50	2,50
174 771 30	60	10F	151,42	158	152,79	110	-	28	32	4	2012	12	50	2,55
174 771 32	64	11F	161,60	168	162,97	110	137	28	32	4	2012	12	50	2,60
174 771 36	72	11F	181,97	192	183,35	110	158	28	32	4	2012	12	50	3,40
174 771 40	80	11	202,35	-	203,72	110	180	28	32	4	2012	12	50	3,60
174 771 45	90	11	227,81	-	229,18	110	204	28	32	4	2012	12	50	4,10

### Timing Belt Width 30 mm

Ordering Details: e.g.: Product No. 174 772 11, Taper-Pulley, 8M, 22 Teeth for Width 30 mm

Product No. Belt Width 30mm	Number of teeth	Type	Outside Ø		d mm	ND mm	D <sub>i</sub> mm	b mm	L mm	R mm	Taper Bush Type page 340	Bore Ø		Weight kg
			Pulley mm	Flange mm								min. mm	max. mm	
174 772 11	22	16F	54,65	60	56,02	-	37	38	22	16	1008	9	25	0,33
174 772 12	24	16F	59,74	66	61,12	-	44	38	22	16	1108	9	28	0,40
174 772 13	26	16F	64,84	71	66,21	-	44	38	22	16	1108	9	28	0,45
174 772 14	28	16F	70,08	75	71,30	-	50	38	25	13	1210	10	32	0,50
174 772 15	30	15F	75,12	83	76,39	-	-	38	38	-	1615	12	42	0,55
174 772 16	32	15F	80,17	87	81,49	-	-	38	38	-	1615	12	42	0,60
174 772 17	34	15F	85,21	91	86,58	-	-	38	38	-	1615	12	42	0,80
174 772 18	36	15F	90,30	97	91,67	-	-	38	38	-	1615	12	42	1,00
174 772 19	38	15F	95,39	103	96,77	-	-	38	38	-	1615	12	42	1,10
174 772 20	40	15F	100,49	106	101,86	-	-	38	38	-	1615	12	42	1,34
174 772 22	44	18F	110,67	119	112,05	-	86	38	32	3	2012	12	50	1,30
174 772 24	48	18F	120,86	127	122,23	-	90	38	32	3	2012	12	50	1,80
174 772 28	56	18F	141,23	148	142,60	-	110	38	32	3	2012	12	50	3,80
174 772 30	60	10F	151,42	158	152,79	125	-	38	45	7	2517	15	65	4,10
174 772 32	64	10F	161,60	168	162,97	125	-	38	45	7	2517	15	65	4,30
174 772 36	72	11F	181,97	192	183,35	125	158	38	45	7	2517	15	65	4,40
174 772 40	80	11	202,35	-	203,72	125	180	38	45	7	2517	15	65	4,65
174 772 45	90	11	227,81	-	229,18	125	204	38	45	7	2517	15	65	5,80

### Timing Belt Width 50 mm

Ordering Details: e.g.: Product No. 174 774 14, Taper-Pulley, 8M, 28 Teeth for Width 50 mm

Product No. Belt Width 50mm	Number of teeth	Type	Outside Ø		d mm	ND mm	D <sub>i</sub> mm	b mm	L mm	R mm	Taper Bush Type page 340	Bore Ø		Weight kg
			Pulley mm	Flange mm								min. mm	max. mm	
174 774 14	28	16F	70,08	75	71,30	-	50	60	25	35	1210	10	32	0,60
174 774 15	30	16F	75,12	83	76,39	-	58	60	38	22	1615	12	42	0,65
174 774 16	32	16F	80,17	87	81,49	-	63	60	38	22	1615	12	42	0,80
174 774 17	34	16F	85,21	91	86,58	-	65	60	38	22	1615	12	42	1,08
174 774 18	36	16F	90,30	97	91,67	-	68	60	38	22	1615	12	42	1,35
174 774 19	38	16F	95,39	103	96,77	-	72	60	38	22	1615	12	42	1,65
174 774 20	40	18F	100,49	106	101,86	-	80	60	32	14	2012	12	50	1,70
174 774 22	44	18F	110,67	119	112,05	-	86	60	32	14	2012	12	50	1,80
174 774 24	48	18F	120,86	127	122,23	-	95	60	32	14	2012	12	50	2,35
174 774 28	56	18F	141,23	148	142,60	-	116	60	45	7,5	2517	15	65	3,35
174 774 30	60	18F	151,42	158	152,79	-	125	60	45	7,5	2517	15	65	4,30
174 774 32	64	18F	161,60	168	162,97	-	136	60	45	7,5	2517	15	65	4,90
174 774 36	72	19F	181,97	192	183,35	125	158	60	45	7,5	2517	15	65	6,90
174 774 40	80	18	202,35	-	203,72	-	180	60	51	4,5	3020	20	75	8,90
174 774 45	90	19	227,81	-	229,18	160	204	60	51	4,5	3020	20	75	9,90

Matching Taper bushes see page 340.  
Mounting instructions see page 867.