

Zahnwellen Zoll-Teilung

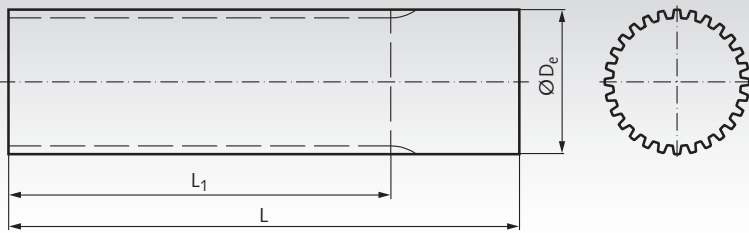

Werkstoff: Aluminium ähnlich EN AW2017A.

Bestellangaben: z.B.: Art.-Nr. 181 912 00, Zahnwellen MXL, Zähnezahl 12

Andere Ausführungen und Werkstoffe auf Anfrage.

Teilung MXL = 0,08"

| Artikel-Nr. | Zähnezahl | D_e mm | L_1 mm | L mm | Gewicht kg |
|-------------|-----------|----------|----------|------|------------|
| 181 912 00 | 12 | 7,25 | 50 | 75 | 0,01 |
| 181 914 00 | 14 | 8,55 | 50 | 75 | 0,01 |
| 181 915 00 | 15 | 9,19 | 50 | 75 | 0,01 |
| 181 916 00 | 16 | 9,84 | 50 | 75 | 0,02 |
| 181 918 00 | 18 | 11,13 | 50 | 75 | 0,02 |
| 181 920 00 | 20 | 12,43 | 90 | 120 | 0,04 |
| 181 922 00 | 22 | 13,72 | 125 | 140 | 0,05 |
| 181 924 00 | 24 | 15,02 | 125 | 140 | 0,06 |
| 181 925 00 | 25 | 15,66 | 125 | 140 | 0,07 |
| 181 926 00 | 26 | 16,31 | 125 | 140 | 0,08 |
| 181 928 00 | 28 | 17,60 | 125 | 140 | 0,09 |
| 181 930 00 | 30 | 18,90 | 125 | 140 | 0,10 |
| 181 932 00 | 32 | 20,19 | 125 | 140 | 0,12 |
| 181 934 00 | 34 | 21,48 | 125 | 140 | 0,13 |
| 181 936 00 | 36 | 22,78 | 140 | 140 | 0,15 |
| 181 940 00 | 40 | 25,36 | 140 | 140 | 0,19 |
| 181 942 00 | 42 | 26,66 | 140 | 140 | 0,20 |
| 181 944 00 | 44 | 27,95 | 140 | 140 | 0,23 |
| 181 945 00 | 45 | 28,60 | 140 | 140 | 0,24 |
| 181 948 00 | 48 | 30,54 | 140 | 140 | 0,27 |
| 181 950 00 | 50 | 31,83 | 140 | 140 | 0,30 |
| 181 960 00 | 60 | 38,30 | 160 | 160 | 0,49 |
| 181 970 00 | 70 | 44,77 | 160 | 160 | 0,67 |
| 181 972 00 | 72 | 46,06 | 160 | 160 | 0,72 |

Teilung XL = 1/5"

| Artikel-Nr. | Zähnezahl | D_e mm | L_1 mm | L mm | Gewicht kg |
|-------------|-----------|----------|----------|------|------------|
| 180 910 00 | 10 | 15,66 | 140 | 140 | 0,07 |
| 180 911 00 | 11 | 17,28 | 140 | 140 | 0,08 |
| 180 912 00 | 12 | 18,90 | 140 | 140 | 0,10 |
| 180 913 00 | 13 | 20,51 | 140 | 140 | 0,11 |
| 180 914 00 | 14 | 22,13 | 140 | 140 | 0,13 |
| 180 915 00 | 15 | 23,75 | 140 | 140 | 0,16 |
| 180 916 00 | 16 | 25,36 | 140 | 140 | 0,18 |
| 180 917 00 | 17 | 26,98 | 140 | 140 | 0,20 |
| 180 918 00 | 18 | 28,60 | 140 | 140 | 0,23 |
| 180 919 00 | 19 | 30,22 | 140 | 140 | 0,26 |
| 180 920 00 | 20 | 31,83 | 140 | 140 | 0,28 |
| 180 921 00 | 21 | 33,45 | 160 | 160 | 0,36 |
| 180 922 00 | 22 | 35,07 | 160 | 160 | 0,40 |
| 180 923 00 | 23 | 36,60 | 160 | 160 | 0,44 |
| 180 924 00 | 24 | 38,30 | 160 | 160 | 0,48 |
| 180 925 00 | 25 | 39,92 | 160 | 160 | 0,51 |
| 180 926 00 | 26 | 41,53 | 160 | 160 | 0,56 |
| 180 927 00 | 27 | 43,15 | 160 | 160 | 0,60 |
| 180 928 00 | 28 | 44,77 | 160 | 160 | 0,65 |
| 180 929 00 | 29 | 46,39 | 160 | 160 | 0,70 |
| 180 930 00 | 30 | 48,00 | 160 | 160 | 0,75 |
| 180 932 00 | 32 | 51,24 | 160 | 160 | 0,87 |
| 180 933 00 | 33 | 52,85 | 160 | 160 | 0,92 |
| 180 934 00 | 34 | 54,47 | 160 | 160 | 0,98 |
| 180 935 00 | 35 | 56,09 | 160 | 160 | 1,04 |
| 180 936 00 | 36 | 57,70 | 160 | 160 | 1,10 |
| 180 938 00 | 38 | 60,94 | 160 | 160 | 1,23 |
| 180 939 00 | 39 | 62,56 | 160 | 160 | 1,30 |
| 180 940 00 | 40 | 64,17 | 160 | 160 | 1,37 |
| 180 941 00 | 41 | 65,79 | 160 | 160 | 1,43 |
| 180 942 00 | 42 | 67,41 | 160 | 160 | 1,51 |
| 180 943 00 | 43 | 69,02 | 160 | 160 | 1,58 |
| 180 944 00 | 44 | 70,64 | 160 | 160 | 1,65 |
| 180 948 00 | 48 | 77,11 | 160 | 160 | 1,98 |
| 180 956 00 | 56 | 90,04 | 160 | 160 | 2,71 |
| 180 960 00 | 60 | 96,51 | 160 | 160 | 3,10 |
| 180 972 00 | 72 | 115,92 | 160 | 160 | 4,52 |

Teilung L = 3/8"

| Artikel-Nr. | Zähnezahl | D_e mm | L_1 mm | L mm | Gewicht kg |
|-------------|-----------|----------|----------|------|------------|
| 182 910 00 | 10 | 29,56 | 140 | 140 | 0,23 |
| 182 911 00 | 11 | 32,59 | 140 | 140 | 0,28 |
| 182 912 00 | 12 | 35,62 | 160 | 160 | 0,39 |
| 182 913 00 | 13 | 38,65 | 160 | 160 | 0,46 |
| 182 914 00 | 14 | 41,68 | 160 | 160 | 0,55 |
| 182 915 00 | 15 | 44,72 | 160 | 160 | 0,63 |
| 182 916 00 | 16 | 47,75 | 160 | 160 | 0,73 |
| 182 917 00 | 17 | 50,78 | 160 | 160 | 0,82 |
| 182 918 00 | 18 | 53,81 | 160 | 160 | 0,93 |
| 182 919 00 | 19 | 56,84 | 160 | 160 | 1,04 |
| 182 920 00 | 20 | 59,88 | 160 | 160 | 1,16 |
| 182 921 00 | 21 | 62,91 | 160 | 160 | 1,28 |
| 182 922 00 | 22 | 65,94 | 160 | 160 | 1,41 |
| 182 923 00 | 23 | 68,98 | 160 | 160 | 1,55 |
| 182 924 00 | 24 | 72,00 | 160 | 160 | 1,69 |
| 182 927 00 | 27 | 81,10 | 160 | 160 | 2,15 |
| 182 930 00 | 30 | 90,20 | 160 | 160 | 2,67 |

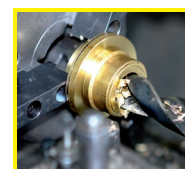

Fertigbearbeitung im
24-Stunden-Service möglich.
Sonderanfertigungen und
Zeichnungsteile auf Anfrage.