

Thermoplastic Rod Ends igubal® KCRM and KCLM similar to DIN ISO 12240-4 (DIN 648) series K, Internal Thread

Material spherical ball: iglidur® W300, yellowish.

Material housing: igumid G, black.



- Maintenance-free, silent running and anti-vibrating.
 - High strength at very low weight.
 - Resistant against corrosion and many chemicals.
 - Electrical and thermal isolating.
 - The counter part must rotate inside the bore of the spherical ball.
- With a metal bolt, a sliding speed up to 30 m/min. may be possible.
The spherical ball may only compensate shaft misalignment.

Temperature range: -30° to +80°C.

IR = Internal Right-hand thread. **IL** = Internal Left-hand thread.

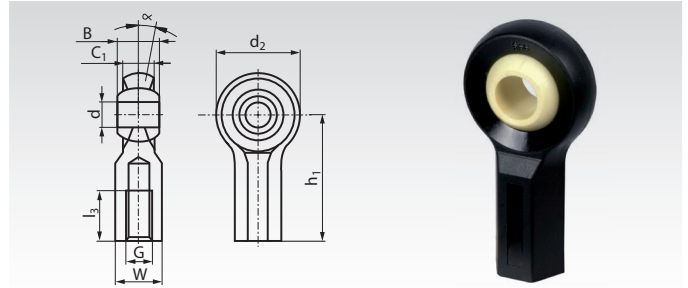

Ordering Details: e.g.: Product No. 632 556 05, Rod End igubal KCRM, 5mm

Product No. KCRM IR	Product No. KCLM IL	d ^{E10} mm	B mm	C ₁ mm	d ₂ mm	h ₁ mm	l ₃ mm	Thread G mm	W mm	Tilting angle α °	Load Rating* radial static N	axial static N	Weight g
632 556 05	632 557 05	5	8	6	18	27	12	M5	SW9	43	600	90	4,0
632 556 06	632 557 06	6	9	7	20	30	13,5	M6	SW10	40	700	150	4,2
632 556 08	632 557 08	8	12	9	24	36	17	M8	SW13	35	1050	250	7,6
632 556 10	632 557 10	10	14	10,5	30	43	22	M10	SW15	35	1500	400	12,8
632 556 10F	632 557 10F	10	14	10,5	30	43	21	M10x1,25	SW15	35	1500	400	12,8
632 556 12	632 557 12	12	16	12	34	50	25	M12	SW17	35	1780	375	19
632 556 12F	632 557 12F	12	16	12	34	50	25	M12x1,25	SW17	35	1780	375	19
632 556 16	632 557 16	16	21	15	42	64	30	M16	SW20	35	1900	400	34
632 556 16F	632 557 16F	16	21	15	42	64	30	M16x1,5	SW20	35	1900	400	34
632 556 20	632 557 20	20	25	18	50	77	35	M20	SW24	35	2275	200	55
632 556 20F	632 557 20F	20	25	18	50	77	35	M20x1,5	SW24	35	2275	200	55

* At short term, the radial load may be twice as high.

Other versions or sizes on request.