

## Gabelgelenke DIN 71752, verzinkt

Werkstoff: Stahl verzinkt.

Ausführung A: Mit Splintbolzen.

Metrisches ISO-Regelgewinde: ohne Zusatz F.

Metrisches ISO-Feingewinde: mit Zusatz F.

Bestellangaben: z.B.: Art.-Nr. 637 001 00,  
Gabelgelenk DIN 71752, A 4 x 8 rechts

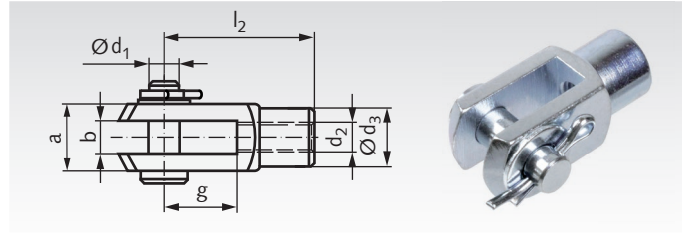

| Artikel-Nr.<br>A rechts | Artikel-Nr.<br>A links | Größe<br>mm | a<br>mm | b<br>mm | d <sub>1</sub><br>mm | d <sub>2</sub><br>mm | Steigung<br>mm | d <sub>3</sub><br>mm | g<br>mm | l <sub>2</sub><br>mm | Gewicht<br>g |
|-------------------------|------------------------|-------------|---------|---------|----------------------|----------------------|----------------|----------------------|---------|----------------------|--------------|
| 637 001 00              | 637 101 00             | 4 x 8       | 8       | 4       | 4                    | M4                   | 0,7            | 8                    | 8       | 16                   | 6            |
| 637 002 00              | 637 102 00             | 4 x 16      | 8       | 4       | 4                    | M4                   | 0,7            | 8                    | 16      | 24                   | 8            |
| 637 003 00              | 637 103 00             | 5 x 10      | 10      | 5       | 5                    | M5                   | 0,8            | 9                    | 10      | 20                   | 10           |
| 637 004 00              | 637 104 00             | 5 x 20      | 10      | 5       | 5                    | M5                   | 0,8            | 9                    | 20      | 30                   | 14           |
| 637 005 00              | 637 105 00             | 6 x 12      | 12      | 6       | 6                    | M6                   | 1,0            | 10                   | 12      | 24                   | 16           |
| 637 006 00              | 637 106 00             | 6 x 24      | 12      | 6       | 6                    | M6                   | 1,0            | 10                   | 24      | 36                   | 23           |
| 637 007 00              | 637 107 00             | 8 x 16      | 16      | 8       | 8                    | M8                   | 1,25           | 14                   | 16      | 32                   | 38           |
| 637 007 00F             | -                      | 8 x 16 F    | 16      | 8       | 8                    | M8x1                 | 1,00           | 14                   | 16      | 32                   | 38           |
| 637 008 00              | 637 108 00             | 8 x 32      | 16      | 8       | 8                    | M8                   | 1,25           | 14                   | 32      | 48                   | 55           |
| 637 008 00F             | -                      | 8 x 32 F    | 16      | 8       | 8                    | M8x1                 | 1,00           | 14                   | 32      | 48                   | 55           |
| 637 009 00              | 637 109 00             | 10 x 20     | 20      | 10      | 10                   | M10                  | 1,5            | 18                   | 20      | 40                   | 80           |
| 637 009 00F             | -                      | 10 x 20 F   | 20      | 10      | 10                   | M10x1,25             | 1,25           | 18                   | 20      | 40                   | 80           |
| 637 010 00              | 637 110 00             | 10 x 40     | 20      | 10      | 10                   | M10                  | 1,5            | 18                   | 40      | 60                   | 120          |
| 637 010 00F             | -                      | 10 x 40 F   | 20      | 10      | 10                   | M10x1,25             | 1,25           | 18                   | 40      | 60                   | 120          |
| 637 011 00              | 637 111 00             | 12 x 24     | 24      | 12      | 12                   | M12                  | 1,75           | 20                   | 24      | 48                   | 125          |
| 637 011 00F             | -                      | 12 x 24 F   | 24      | 12      | 12                   | M12x1,25             | 1,25           | 20                   | 24      | 48                   | 125          |
| 637 012 00              | 637 112 00             | 12 x 48     | 24      | 12      | 12                   | M12                  | 1,75           | 20                   | 48      | 72                   | 180          |
| 637 012 00F             | -                      | 12 x 48 F   | 24      | 12      | 12                   | M12x1,25             | 1,25           | 20                   | 48      | 72                   | 180          |
| 637 013 00              | 637 113 00             | 14 x 28     | 27      | 14      | 14                   | M14                  | 2,0            | 24                   | 28      | 56                   | 190          |
| 637 013 00F             | -                      | 14 x 28 F   | 27      | 14      | 14                   | M14x1,5              | 1,5            | 24                   | 28      | 56                   | 190          |
| 637 014 00              | 637 114 00             | 14 x 56     | 27      | 14      | 14                   | M14                  | 2,0            | 24                   | 56      | 85                   | 265          |
| 637 014 00F             | -                      | 14 x 56 F   | 27      | 14      | 14                   | M14x1,5              | 1,5            | 24                   | 56      | 85                   | 265          |
| 637 015 00              | 637 115 00             | 16 x 32     | 32      | 16      | 16                   | M16                  | 2,0            | 26                   | 32      | 64                   | 300          |
| 637 015 00F             | -                      | 16 x 32 F   | 32      | 16      | 16                   | M16x1,5              | 1,5            | 26                   | 32      | 64                   | 300          |
| 637 016 00              | 637 116 00             | 16 x 64     | 32      | 16      | 16                   | M16                  | 2,0            | 26                   | 64      | 96                   | 430          |
| 637 016 00F             | -                      | 16 x 64 F   | 32      | 16      | 16                   | M16x1,5              | 1,5            | 26                   | 64      | 96                   | 430          |
| 637 020 00              | 637 120 00             | 20 x 40*    | 40      | 20      | 20                   | M20                  | 2,5            | 34                   | 40      | 80                   | 680          |

\* Größe 20 ist nicht in der DIN enthalten.

## Gabelgelenke ähnlich DIN 71752, Edelstahl

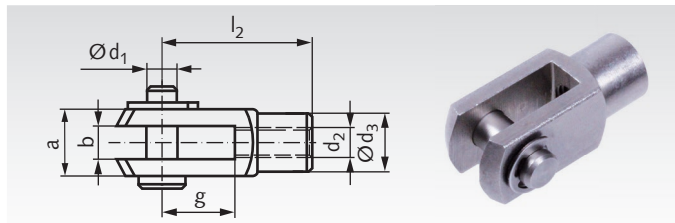

Werkstoff: Edelstahl 1.4301 (V2A).

Ausführung A: Mit Bolzen mit Sicherungsring.

Bestellangaben: z.B.: Art.-Nr. 637 990 01, Gabelgelenk DIN 71752, A 4 x 8 rechts, rostfrei

## Gabelköpfe ähnlich DIN 71752, Edelstahl

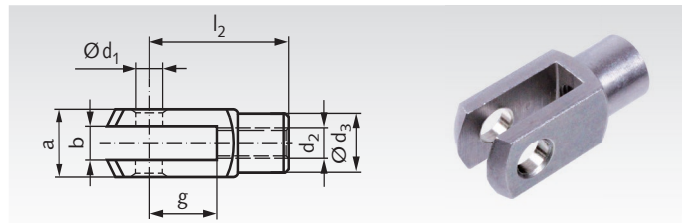

Werkstoff: Edelstahl 1.4301 (V2A).

Ausführung G: ohne Bolzen.

Bestellangaben: z.B.: Art.-Nr. 637 992 01, Gabelkopf DIN 71752, G 4 x 8 rechts, rostfrei

| Artikel-Nr.<br>A rechts | Artikel-Nr.<br>A links | Artikel-Nr.<br>G rechts | Artikel-Nr.<br>G links | Größe<br>mm | a<br>mm | b<br>mm | d <sub>1</sub><br>mm | d <sub>2</sub><br>mm | d <sub>3</sub><br>mm | g<br>mm | l <sub>2</sub><br>mm | Gewicht |        |
|-------------------------|------------------------|-------------------------|------------------------|-------------|---------|---------|----------------------|----------------------|----------------------|---------|----------------------|---------|--------|
|                         |                        |                         |                        |             |         |         |                      |                      |                      |         |                      | A<br>g  | G<br>g |
| 637 990 01              | 637 991 01             | 637 992 01              | 637 993 01             | 4 x 8       | 8       | 4       | 4                    | M4                   | 8                    | 8       | 16                   | 6       | 5      |
| 637 990 02              | 637 991 02             | 637 992 02              | 637 993 02             | 4 x 16      | 8       | 4       | 4                    | M4                   | 8                    | 16      | 24                   | 8       | 7      |
| 637 990 03              | 637 991 03             | 637 992 03              | 637 993 03             | 5 x 10      | 10      | 5       | 5                    | M5                   | 9                    | 10      | 20                   | 10      | 9      |
| 637 990 04              | 637 991 04             | 637 992 04              | 637 993 04             | 5 x 20      | 10      | 5       | 5                    | M5                   | 9                    | 20      | 30                   | 14      | 13     |
| 637 990 05              | 637 991 05             | 637 992 05              | 637 993 05             | 6 x 12      | 12      | 6       | 6                    | M6                   | 10                   | 12      | 24                   | 16      | 15     |
| 637 990 06              | 637 991 06             | 637 992 06              | 637 993 06             | 6 x 24      | 12      | 6       | 6                    | M6                   | 10                   | 24      | 36                   | 23      | 22     |
| 637 990 07              | 637 991 07             | 637 992 07              | 637 993 07             | 8 x 16      | 16      | 8       | 8                    | M8                   | 14                   | 16      | 32                   | 38      | 37     |
| 637 990 08              | 637 991 08             | 637 992 08              | 637 993 08             | 8 x 32      | 16      | 8       | 8                    | M8                   | 14                   | 32      | 48                   | 55      | 54     |
| 637 990 09              | 637 991 09             | 637 992 09              | 637 993 09             | 10 x 20     | 20      | 10      | 10                   | M10                  | 18                   | 20      | 40                   | 80      | 74     |
| 637 990 10              | 637 991 10             | 637 992 10              | 637 993 10             | 10 x 40     | 20      | 10      | 10                   | M10                  | 18                   | 40      | 60                   | 120     | 116    |
| 637 990 11              | 637 991 11             | 637 992 11              | 637 993 11             | 12 x 24     | 24      | 12      | 12                   | M12                  | 20                   | 24      | 48                   | 125     | 121    |
| 637 990 12              | 637 991 12             | 637 992 12              | 637 993 12             | 12 x 48     | 24      | 12      | 12                   | M12                  | 20                   | 48      | 72                   | 180     | 175    |
| 637 990 13              | 637 991 13             | 637 992 13              | 637 993 13             | 14 x 28     | 27      | 14      | 14                   | M14                  | 24                   | 28      | 56                   | 190     | 178    |
| 637 990 14              | 637 991 14             | 637 992 14              | 637 993 14             | 14 x 56     | 27      | 14      | 14                   | M14                  | 24                   | 56      | 85                   | 265     | 258    |
| 637 990 15              | 637 991 15             | 637 992 15              | 637 993 15             | 16 x 32     | 32      | 16      | 16                   | M16                  | 26                   | 32      | 64                   | 300     | 282    |
| 637 990 16              | 637 991 16             | 637 992 16              | 637 993 16             | 16 x 64     | 32      | 16      | 16                   | M16                  | 26                   | 64      | 96                   | 430     | 410    |
| 637 990 20              | -                      | 637 992 20              | -                      | 20 x 40*    | 40      | 20      | 20                   | M20                  | 34                   | 40      | 80                   | 680     | 600    |

\* Größe 20 ist nicht in der DIN enthalten.